

Installation & Wiring Instructions

OLP/1 - LED Bulkhead



PLEASE READ THESE INSTRUCTIONS BEFORE COMMENCING INSTALLATION & LEAVE WITH END USER

Description:

The OLP/1 bulkhead is a robust IP65 luminaire which offers 1,163 lumen in mains operation and 358 lumen emergency operation.

The OLP/1 is manufactured with an opal diffuser which casts the light well over a wide arc. The Makralon diffuser offers a high light output ratio (LOR) maximising the light from the LED chips. Ldt files in both mains and emergency operation are available, please contact the Liteplan sales office who will be happy to send them to you.

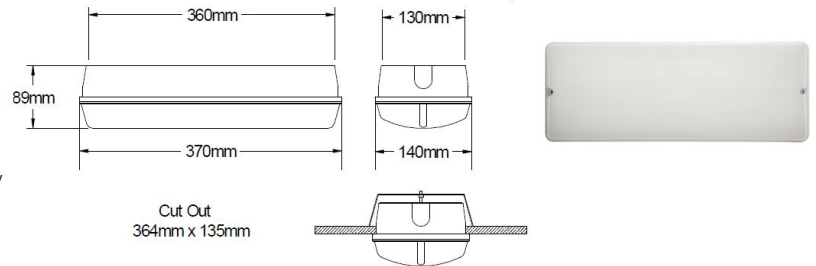

The LiteMesh wireless version should be wired in the same way as basic the emergency version. Communication will be established during the commissioning process.

The product features battery temperature protection in accordance with IEC 61347-2-7: 2012+A12:2022.

Specification:

Input Voltage	230-240 Volts AC 50/60 Hz
Power Rating (Non-Maintained) *	1.3W 13mA - $\lambda = 0.67$
Power Rating (Maintained)	10.7W 57mA $\lambda = 0.78$
Ambient Temp.	0°C to + 35°C
Mains Input Terminal	0.5mm - 2.5mm
Battery Fuse	Internal to Em Module
Battery Discharge Current	900mA
Discharge Voltage Limit	2.4V
Ingress Protection	IP65
Battery Pack	3.2V 3.8Ah LiFePO4
Charge Current	225mA Nominal
Recharge Period	24 Hours
Width and Length	370mm 140mm
Depth	89mm
Side Cable Entry	20mm Knock Outs L&R
Rear Cable Entry	20mm Knock Out Centre
Overall Weight (maintained)	1.7Kg

* After its initial charge, the OLP will spend 90% of its operational life in standby mode

Product codes

OLP/1/NM
OLP/1/M
OLP/1/NM/LMEM
OLP/1/M/LMEM

Non-maintained Bulkhead
Maintained Bulkhead
Non-maintained Wireless Bulkhead
Maintained Wireless Bulkhead

Important

It is recommended that this product is installed by a competent person in accordance with the current building and wiring regulations. Liteplan accept no responsibility for injury, damage or loss, which may arise as a result of incorrect installation, operation or maintenance.

The product requires an un-switched supply for charging the battery and a switched supply for maintained operation.

ISOLATE MAINS SUPPLIES AND DISCONNECT THE BATTERY BEFORE INSTALLATION OR MAINTENANCE.

Installation:

1. Remove the two front screws and lift off diffuser.
2. Remove the two screws on the hinged geartray and lift to reveal the components underneath.
3. Open your desired cable entry and feed mains cable through. Use the required IP rated gland to ensure that IP rating is maintained.
4. Connect the cables to the terminal block as shown in the diagram overleaf.
5. For Non-Maintained operation, do not connect to the Switched Live terminal.
6. Connect the battery.
7. Screw the geartray back into position ensuring no cables are trapped.
7. Refit the cover.
8. Fit the screws back into the diffuser making a water tight seal.

Tel +44 (0)1708 372223 | www.liteplan.com | customerservice@liteplan.com | RM3 OAP. UK

Liteplan reserve the right to change colour, price or specification without prior notice

ISS 250325



Installation & Wiring Instructions
OLP/1 -
LED Bulkhead

PLEASE READ THESE INSTRUCTIONS BEFORE COMMENCING INSTALLATION & LEAVE WITH END USER

Typical Wiring
Diagram

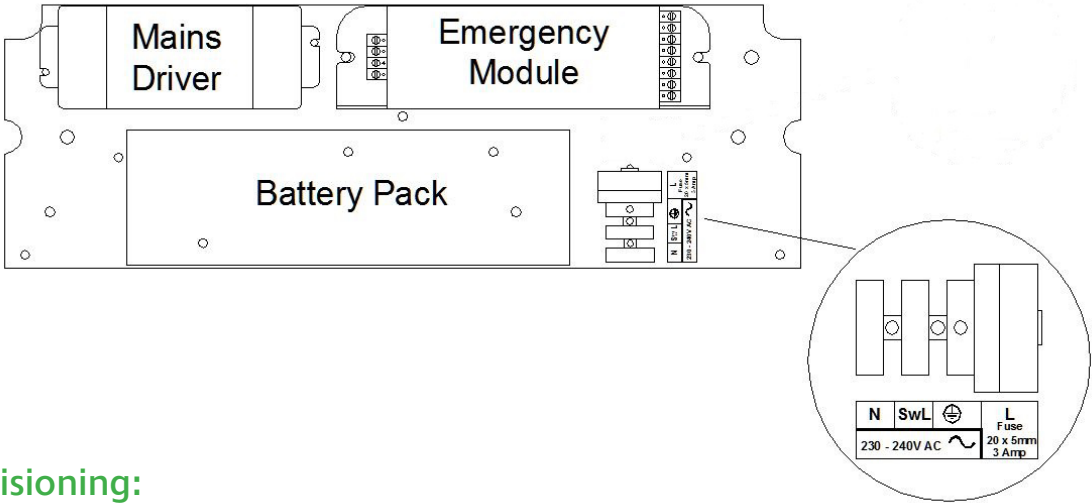

Testing/Commisioning:

- Ensure the power is connected.
- Connect the battery.
- Switch on the Un-switched Supply - Check the Charge LED illuminates.
- Switch off the Un-switched Supply - Check the Charge LED extinguishes and the load LED illuminates.
- Enter the commissioning date on the Battery Pack.
- Switch on the Un-switched Supply
- If the battery case temperature falls below 0°C or goes above 55°C the charger will cut-off and the charge LED will go out.

Luminaire Ref/Location			In case of difficulty, contact the Installation Engineers:-							
			Tel:							
Full Recharge Time 24 Hours			Duration 3 Hours				Lamp Type - LED			
ROUTINE TEST RECORD										
	Year 1		Year 2		Year 3		Year 4		Year 5	
Monthly Test	Signed	Date	Signed	Date	Signed	Date	Signed	Date	Signed	Date
Functional										
Functional										
Functional										
Functional										
Functional										
Functional										
Functional										
Functional										
Functional										
Functional										
Functional										
Three Hour										