

# Technical Specification

## OLP/1/CASAMBI

### Emergency Bulkhead

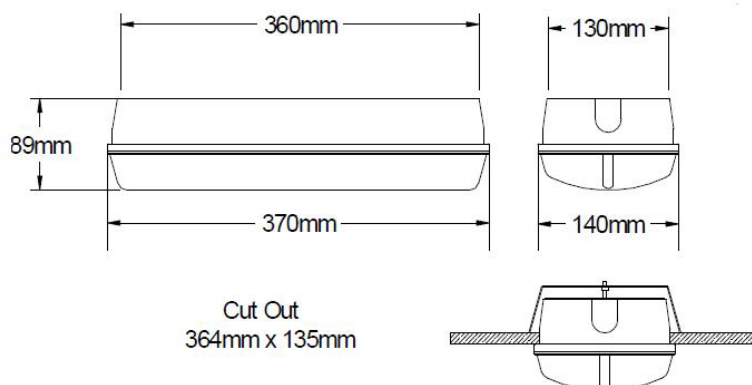

- IP65 Ingress Protection
- Ready for Connection to Casambi
- 1163 Lumen in Mains Operation
- 358 Lumen in Emergency Operation
- Makrolon Diffuser with High LOR
- Photometrically Tested by Lux TSI
- Extra Long Life LiFePO4 Batteries
- Can be supplied with Exit Legend

The OLP/1/CASAMBI is a high quality emergency LED bulkhead which is designed for interior and exterior applications.

The high output LED strip provides 1163 lumen in mains operation and 358 lumen in emergency operation after the diffuser.

This product is supplied ready to connect to a Casambi wireless control system.

### Order Codes:

**OLP/1/NM/CASAMBI** Non-Maintained Casambi Ready IP65 LED Bulkhead

**OLP/1/M/CASAMBI** Maintained Casambi Ready IP65 LED Bulkhead

### Spacing Table:

Mounting	Axial to Wall		Axial to Axial		Transverse to Axial		Transv. to Transv.		Transverse to Wall	
Height	0.5 Lux	1.0 Lux	0.5 Lux	1.0 Lux	0.5 Lux	1.0 Lux	0.5 Lux	1.0 Lux	0.5 Lux	1.0 Lux
2.5m	2.9m	2.3m	9.7m	7.0m	10.9m	8.5m	13.2m	11.2m	5.6m	4.5m
3.0m	3.0m	2.5m	8.3m	6.0m	11.4m	9.1m	14.5m	12.2m	6.1m	4.6m
4.0m	3.4m	2.5m	8.4m	6.8m	12.6m	9.9m	16.7m	13.0m	6.5m	4.8m
5.0m	3.6m	2.4m	9.0m	7.1m	13.4m	10.3m	17.9m	13.4m	6.7m	4.3m
6.0m	3.6m	1.5m	9.8m	7.2m	14.2m	10.3m	18.6m	13.4m	6.7m	2.6m
8.0m	2.7m	-	10.1m	5.3m	14.7m	7.2m	19.2m	9.1m	4.5m	-

### Technical Details:

Input Voltage	230-240 Volts 50/60Hz	Mains Output	1163 Lumen
Power Rating (Non-Maintained) *	2.9W 18mA $\lambda = 0.66$	Emergency Output	358 Lumen
Power Rating (Maintained)	11.5W 100mA $\lambda = 0.48$	Ambient Temp (Ta)	25 °
Emergency Duration	3-Hours	Battery Type	3.2V 3.8Ah LiFePO4
Light Source	V-S 23.5V 8.23W	Mains Cable Terminal	0.5mm x 2.5mm Cable
Beam Angle	125° x 117°	Ingress Protection	IP65
Light Source Colour Temperature	4000K	Dimensions	370mm x 140mm x 89mm
		Weight	2.1Kg

\* After initial charge, the OLP/1 will spend 90% of its operational life in standby mode.

Tel +44 (0)1708 372223 | [www.liteplan.com](http://www.liteplan.com) | [customerservice@liteplan.com](mailto:customerservice@liteplan.com) | RM3 0AP. UK

Liteplan reserve the right to change colour, price or specification without prior notice