

Installation & Wiring Instructions

TNA/2/SP85/R High Output High Voltage DALI Self-Test Remote Conversion Kit

PLEASE READ THESE INSTRUCTIONS BEFORE COMMENCING INSTALLATION & LEAVE WITH END USER

Description:

The Liteplan range of TNA/2/SP85/R DALI self-test remote modules are designed to convert a wide range of LED types. The TNA/2/SP85/R converts most higher voltage LED luminaires and arrays. The modules are designed to be installed by breaking into the low voltage connection between the mains driver and the LEDs and allows the LEDs to be operated as normal under mains healthy conditions and operated at reduced output in emergency.

The modules automatically adjusts the output LED current to provide the best match between the battery and the load, providing maximum illumination whilst ensuring full battery duration and are compatible with a wide range of lighting.

In some cases the TNA/2/SP85/R can be used to power some GU10 and mains fed lamps. Contact the office for compatibility. The unit will recharge the batteries after the test of clause 22.3 of BS EN 61347-2-7:2012.

The battery is fitted with a PCM to protect the supply voltage against reverse polarity.

Specification:

Input Voltage	230-240 Volts AC 50/60 Hz
Power Rating (charging)	3.8W - 21mA - $\lambda = 0.77$
Power Rating (standby)	1.3W - 13mA - $\lambda = 0.45$
Insulation between supply & battery	Double Reinforced
Duration	3-hours
Ambient Temp. Ta	0°C to + 50°C
Max Case Temp. Tc	70°C
Max Battery Temperature	55°C
Recharge Period	24-Hours
Battery Type	6.4V 3.8Ah LiFePO4
Charge Current	225mA Nominal
Discharge Current	900mA nominal
Charge Voltage Limit	7.0 Volts
Discharge Voltage Limit	5.0 Volts
Ingress Protection	IP20
Recharge Period	24-Hours
Module Size (L x W x H)	320mm x 75mm x 31mm
Module Fixing Centers	305mm
Remote Weight	0.9Kg

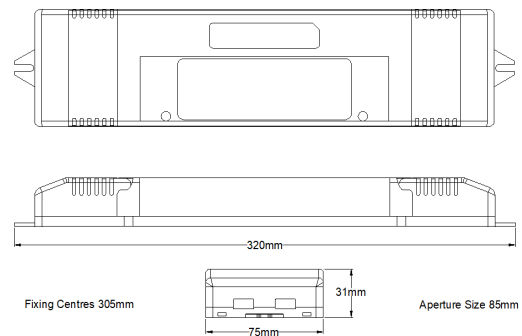

TNA/2/SP85/R Prated - 4.4W
 Irated - 88-14mA
 Voltage Range 50 - 300 Volts
 Open Circuit Voltage (U-OUT) = 350 Volts

Warning

Avoid running the LED mains driver and emergency pack without the load connected. Failure to do so may result in damage to the LED array

Important

It is recommended that the module is installed by a competent person ensuring the installation complies with the necessary standards. Liteplan accept no responsibility for injury, damage or loss, which may arise as a result of incorrect installation, operation or maintenance.

The conversion requires an unswitched supply for charging the battery and a switched supply if the unit is being used for maintained operation.

ISOLATE BOTH MAINS SUPPLIES AND DISCONNECT THE BATTERY BEFORE INSTALLATION OR MAINTENANCE.

Installation

When converting a luminaire observe the following points:-

1. Ensure that the module and battery pack will operate within their temperature ratings at their chosen location.
2. Ensure that the interconnecting loom is kept as short as possible.
3. Ensure that the Permanent Live & Switched Live feeds are connected correctly.
4. Arrange the wiring to avoid running the 240 Volt cables next to the modules output to the LED to obtain the best EMC results.
5. Requirements for 'F' markings must be observed.
6. Identify clearly the NEW Un-switched supply.
7. Ensure the LED Charge Indicator is clearly visible in every day use.
8. Connect the battery connector that can be found under the inspection cover.
9. This module is not intended for use in luminaires for high-risk task area lighting.
10. This module is protected against battery polarity reversal.

Installation & Wiring Instructions

TNA/2/SP85/R High Output High Voltage DALI Self-Test Remote Conversion Kit



PLEASE READ THESE INSTRUCTIONS BEFORE COMMENCING INSTALLATION & LEAVE WITH END USER

Typical
Conversion
Wiring Diagram

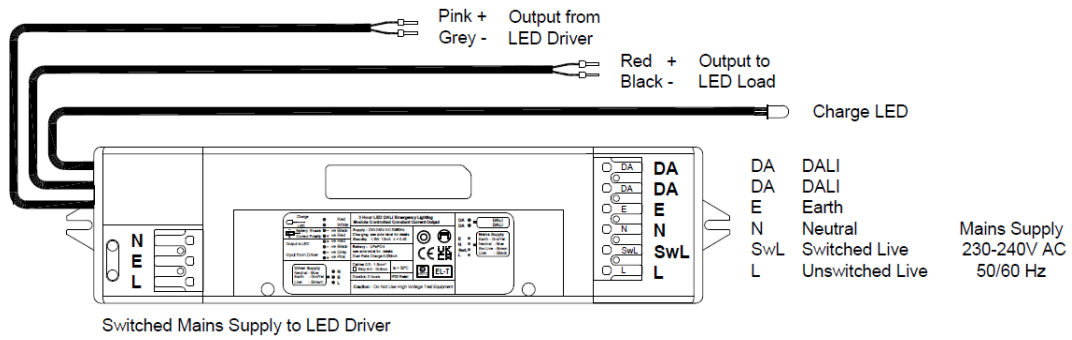

Device Status Indicator:

Green Solid		Battery connected & charging	Red Fast Flash 2 x 0.5 sec On, 2.5 sec Off	Lamp Fault
Green Flash	2.0 sec On, 0.2 sec Off	48h Pre-Commissioning	Red Slow Flash 0.5 sec On, 3.5 sec Off	Battery Fault
Green Flash	0.2 sec On, 2.0 sec Off	Function Test in progress	Red / Green Alternating	Identification Mode
Green Flash	0.2 sec On, 2.0 sec Off	Duration Test in progress	Red & Green Off	In Emergency Mode

Luminaire Ref/Location		In Case of difficulty, contact the Installation Engineers:-									
.....		Tel:.....									
Full Recharge Time 24 Hours			Duration 3 Hours				Lamp Type - LED				
ROUTINE TEST RECORD											
	Year 1		Year 2		Year 3		Year 4		Year 5		
Monthly Test	Signed	Date	Signed	Date	Signed	Date	Signed	Date	Signed	Date	
Functional											
Functional											
Functional											
Functional											
Functional											
Functional											
Functional											
Functional											
Functional											
Functional											
Three Hour											

Tel +44 (0)1708 372223 | www.liteplan.com | customerservice@liteplan.com | RM3 0AP. UK

Liteplan reserve the right to change colour, price or specification without prior notice

ISS 200323

