

Installation & Wiring Instructions

OLP/2/DA High Output DALI Self-Test Bulkhead

PLEASE READ THESE INSTRUCTIONS BEFORE COMMENCING INSTALLATION & LEAVE WITH END USER

Description:

The OLP/2/DA DALI self-test bulkhead is a robust IP65 luminaire which offers 950 lumen in mains operation and 600 lumen in emergency operation. The high emergency output provided by this product in emergency makes it perfect for high ceilings.

The OLP/2/DA is manufactured with an opal diffuser which casts the light well over a wide arc and with a high light output ratio (LOR). Ldt files in both mains and emergency operation are available, please contact the Liteplan sales office who will be happy to send them to you.

If not connected to a DALI system, the OLP/2/DA will revert to standalone self-test operation.

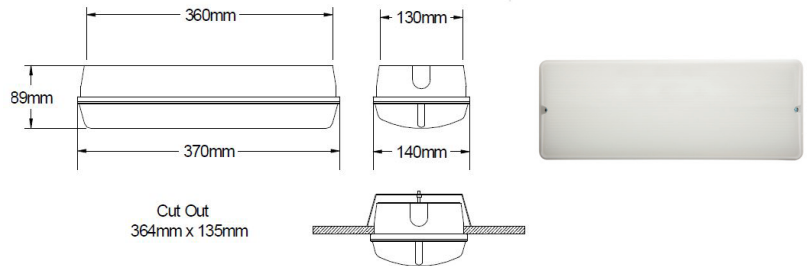

Specification:

Input Voltage	230-240 Volts AC 50/60 Hz
Power Rating (Non-Maintained) *	3.6W 19.8mA - $\lambda = 0.77$
Power Rating (Maintained)	12.4W 70.7mA $\lambda = 0.73$
Ambient Temp.	0°C to + 25°C
Mains Input Terminal	0.5mm - 2.5mm
Battery Fuse	Internal to DNA/2
Battery Discharge Current	900mA
Discharge Voltage Limit	5.0V
Ingress Protection	IP65
Battery Pack	6.4V 4.8Ah LiFePO4
Charge Current	225mA Nominal
Recharge Period	24-Hours
Width and Length	370mm 140mm
Depth	89mm
Side Cable Entry	20mm Knock Outs L&R
Rear Cable Entry	20mm Knock Out Centre
Overall Weight (M3)	1.9Kg

* Following its initial charge the OLP/2/DA will spend 90% of its operational life in standby mode

Product codes

OLP/2/DA/NM	Non-maintained DALI Self-Test 3 hour
OLP/2/DA/M	Maintained DALI Self-Test 3 hour (Basic mains)
OLP/2/DA/MD	Maintained DALI Self-Test 3 hour (DALI mains)

Important

It is recommended that this product is installed by a competent person in accordance with the current building and wiring regulations.. Liteplan accept no responsibility for injury, damage or loss, which may arise as a result of incorrect installation, operation or maintenance.

The product requires an un-switched supply for charging the battery and a switched supply for maintained operation.

ISOLATE MAINS SUPPLIES AND DISCONNECT THE BATTERY BEFORE INSTALLATION OR MAINTENANCE.

Installation:

1. Remove the two front screws and lift off diffuser.
2. Remove the two screws on the hinged geartray and lift to reveal the components underneath.
3. Open your desired cable entry and feed mains cable through. Use the required IP rated gland to ensure that IP rating is maintained.
4. Connect the cables to the terminal blocks as shown in the diagram overleaf.
5. For Non-Maintained operation, do not connect to the Switched Live terminal.
6. Connect the battery.
7. Screw the geartray back into position ensuring no cables are trapped.
7. Refit the cover.
8. Fit the screws back into the diffiser making a water tight seal.

Installation & Wiring Instructions

OLP/2/DA High Output DALI Self-Test Bulkhead



PLEASE READ THESE INSTRUCTIONS BEFORE COMMENCING INSTALLATION & LEAVE WITH END USER

Typical Wiring Diagram

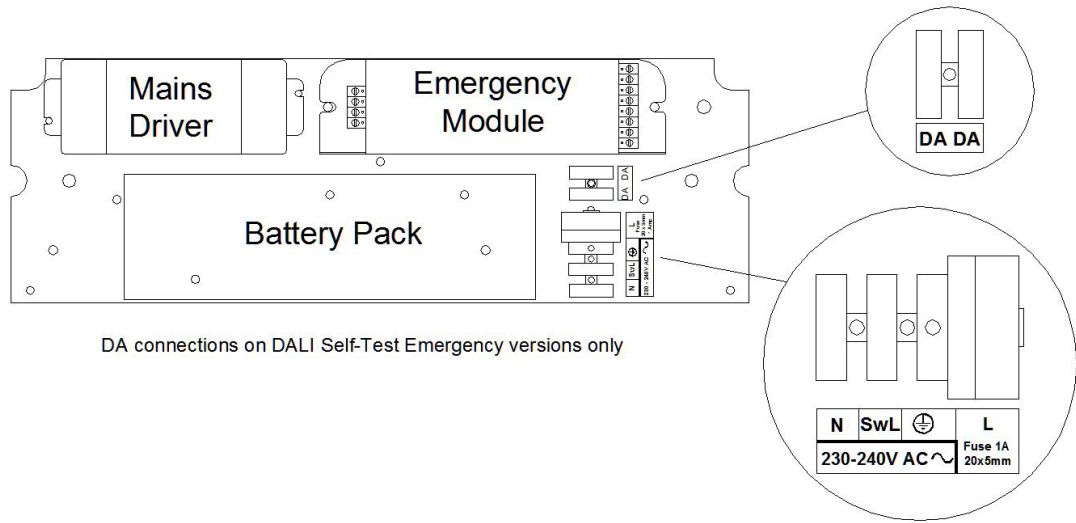

Device Status Indicator:

Green Solid		Battery connected & charging	Red Solid		Emergency LED Fault
Green Fast Flash	0.1 sec On, 0.1 sec Off	Function Test in progress	Red Fast Flash	0.1 sec On, 0.1 sec Off	LED Driver Fault
Green Slow Flash	1.0 sec On, 1.0 sec Off	Duration Test in progress	Red Slow Flash	1.0 sec On, 1.0 sec Off	Battery Fault
Green Very Slow Flash	4.0 sec On, 1.0 sec Off	Automatic Duration Test Passed in last 7 days	Red / Green Alternating		Identification Mode
			Red & Green Off		In Emergency Mode

Luminaire Ref/Location		In case of difficulty, contact the Installation Engineers:- Tel: _____								
Full Recharge Time 24 Hours		Duration 3 Hours			Lamp Type - LED					
ROUTINE TEST RECORD										
	Year 1		Year 2		Year 3		Year 4		Year 5	
Monthly Test	Signed	Date	Signed	Date	Signed	Date	Signed	Date	Signed	Date
Functional										
Functional										
Functional										
Functional										
Functional										
Functional										
Functional										
Functional										
Functional										
Functional										
Functional										
Three Hour										

Tel +44 (0)1708 372223 | www.liteplan.com | customerservice@liteplan.com | RM3 0AP. UK

Liteplan reserve the right to change colour, price or specification without prior notice